



**BENJAMIN
STEVENS.**
estate agents



Flat 24 Bletchley Court, Hitchin Lane, Stanmore, HA7 1FP

Offers In Excess Of £399,950

A Two Bedroom Ground Floor Apartment only yards from Canons Park station.

The property comprises of two bedrooms and an open plan kitchen/reception room.

The main features of this property is you have an allocated parking space and a long lease.

The property is located minutes away from Canons Park Station and close to local shops and schools.

There is a children's play area and nursery closely located to the property.

Call Benjamin Stevens to view now!

Exterior



Bedroom One 13'10" x 9'8" (4.22 x 2.95)



Reception 18'6" x 15'8" (5.64 x 4.78)



Bedroom Two 20'0" x 10'7" (6.10 x 3.25)



Kitchen



Family Bathroom



Parking



Tenure

Lease- 111 years remaining

Ground Rent- £0

Service Charge- £2,743.80 (£228.64 per month)

Council Tax- D (Harrow)

Floor Plan

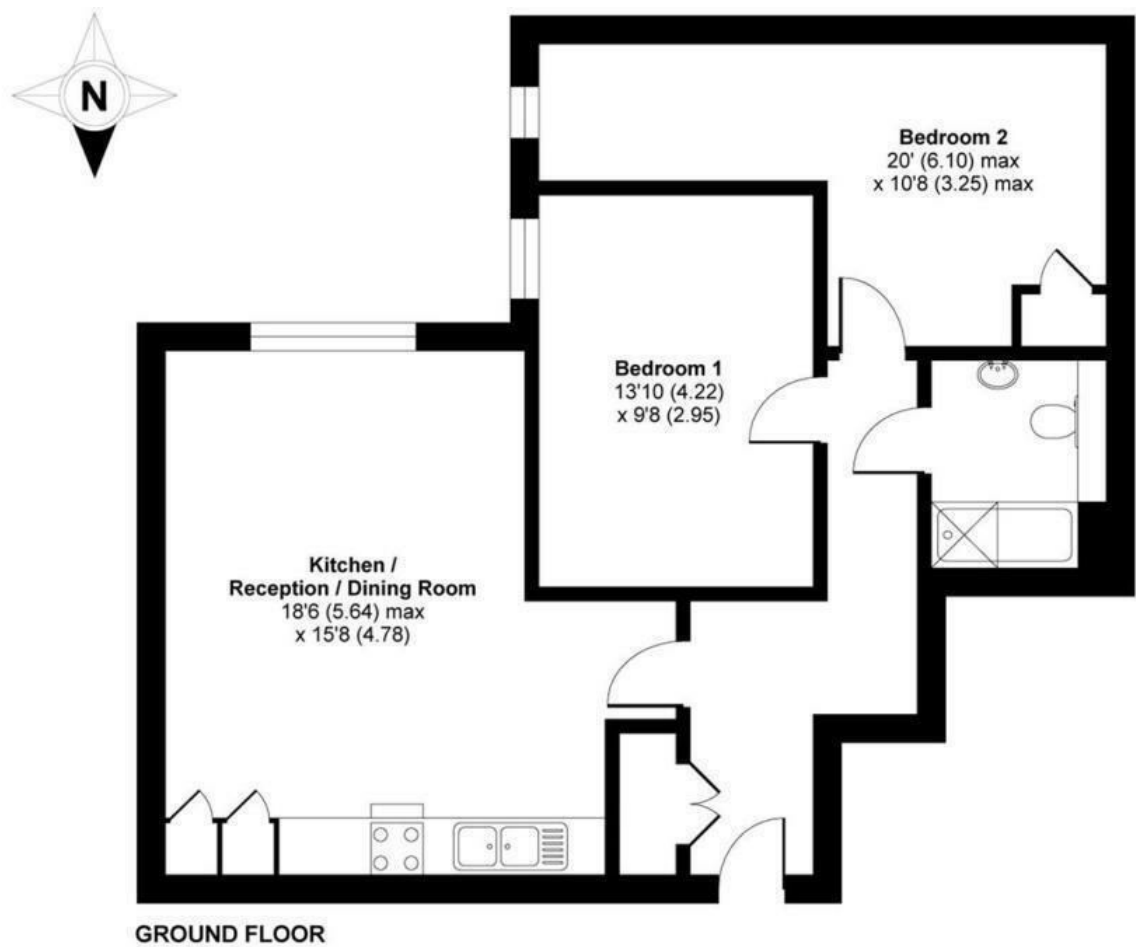

Area Map



Energy Efficiency Graph

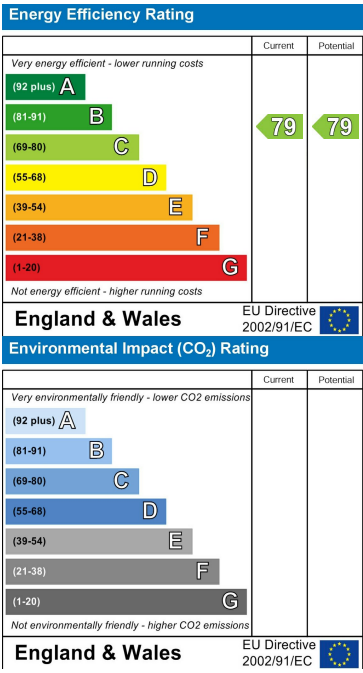

These particulars, whilst believed to be accurate are set out as a general outline only for guidance and do not constitute any part of an offer or contract. Intending purchasers should not rely on them as statements of representation of fact, but must satisfy themselves by inspection or otherwise as to their accuracy. No person in this firms employment has the authority to make or give any representation or warranty in respect of the property.

